



## 110" PRVFMX2G110AI

### 110" DV-LED Gen.2 FusionMax 2Go Foldable Mobile All-In-One Display

PrimeView's 2nd generation foldable mobile DVLED display offers some of the crispest, clearest, and brightest images on the market.

Based on 4th generation cutting-edge Fusion Series DVLED displays, this new series offers more for less.

The 2nd generation FusionMax 2GO™ now offers TWO sizes of foldable mobile solutions in 110" & 138" as stock products.

These 2 new models offer a full GOB solution, with high brightness yet less power consumption, for a greener environment and cost reduction.

These industrial 24/7 rated LED display walls are reliable and dynamic, perfect for broadcast studios, retail stores, and corporate settings.

With their segmental design and innovative full front-serviceability, clients can utilize their creativity for brilliant high-impact branding walls and one-of-a-kind digital art. with a simple GUI that anyone can use.



### Features

- 110" DV-LED Display with real 1920x1080@60Hz 16:9 Resolution
- Easily folded into a travel case for safe storage or transportation
- Up/Down lifting by electric lift
- Fast & Easy installation
- Easily transport in elevators or narrow doors
- Plug-and-play operation, Ready to work in minutes after storage
- Internal Android player for direct browsing and image or video displays
- HDMI & Type-C Inputs for external source viewing
- Simple and easy maintenance
- Front Buttons + IR Controller for full display control.

### Applications

Corporate, Gaming and Hospitality, Digital Signage, Retail, Higher Education, Art Galleries, Healthcare & Industrial.

# 110" PRVFMX2G110AI | Technical Specification

## Display Parameter

Display Parameters	
Size	110"
Pixel Pitch (mm)	1.2
Display Ratio	16:9
Resolution (dots)	1920×1080
LED Type	GOB
Active Display area size (W*H)	2440 x 1372 mm   96.06 inch x 54.01 inch
Unfolded Display size (W*H*D)	2453 x 2318 x 780mm   96.57 inch x 91.25 inch x 30.7 inch
Folded Display size (W*H*D)	1360 x 1817 x 780 mm   53.54 inch x 71.53 inch x 30.7 inch
Display Height (Min/Max)	1817 mm(Min.)~2318 mm(Max.)   71.53 inch (Min.)~91.25 inch(Max.)
Module Size (W*H)	152.5 × 343   6.0 inch x 12.29 inch
Cabinet Size (W*H*D)	610 × 343 × 31   24.01 inch x 13.50 inch x 1.22 inch
Cabinet Qty	4x4
Weight	210 Kg.   462.9 lbs.
Optimum Viewing Distance	≥1.5 Meters   ≥ 59 inch
Maintenance	Front Access
Installation Mode	Floor

System Parameter	
Operating System	Android 9.0
CPU	Cortex-A72*2+ Cortex-A53*4 Frequency: 2.0GHz
RAM	4GB
Storage	32GB
Media Format Supports	Video- MPEG1, MPEG2, MPEG4, WMV, MKV, TS, flv, and other mainstream video formats; Audio- MP3 and other audio formats
	Picture- JPG, JPEG, BMP, PNG, GIF and other image format

Optical Parameter	
Brightness (Nits)	100~550
Refresh Rate (Hz)	3840
Gray Scale (bit)	14
Contrast Ratio	1:6500
Color Temperature	6500-9300K
Viewing Angle (H/V)	170°/170°
LED Life Time (hrs)	≥100,000

# 110" PRVFMX2G110AI | Technical Specification

## Display Parameter

Electrical Parameter	
Input Voltage (V)	100-240v AC 50/60Hz
Standby Power Consumption	(W) ≤0.5
Average Power Consumption	(KW) 0.66
Maximum Power Consumption	(KW) 1.66

Environmental Parameter	
Working Temperature	-10°c- 40°c 14°f- 104°f
10%-80%-Working Humidity (RH)	10%-80%- No Condensation

Type	
HDMI IN	3 (2 Internal & 1 External)
USB2.0	1 (External)
USB3.0	1 (External)
Type C	1 (External)
3.5mm Audio OUT	2 (1 Internal & 1 External)
Audio OUT(OPTICAL)	1 (Internal )
RS232 Port	1 (Internal )
RS485 Port	1 (Internal )
LAN Port	1 (Internal )

Accessories	
Remote Control	1
Front Access Tool	1
Installation kit	1
Wireless Dongle	Optional

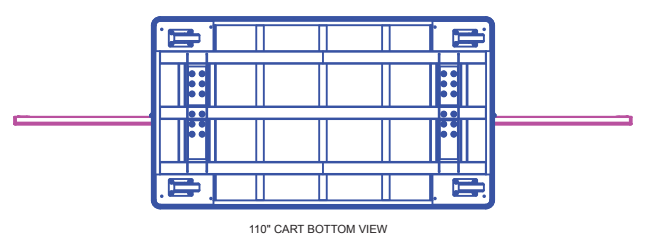
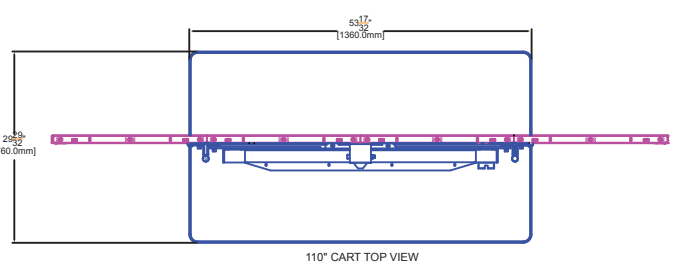
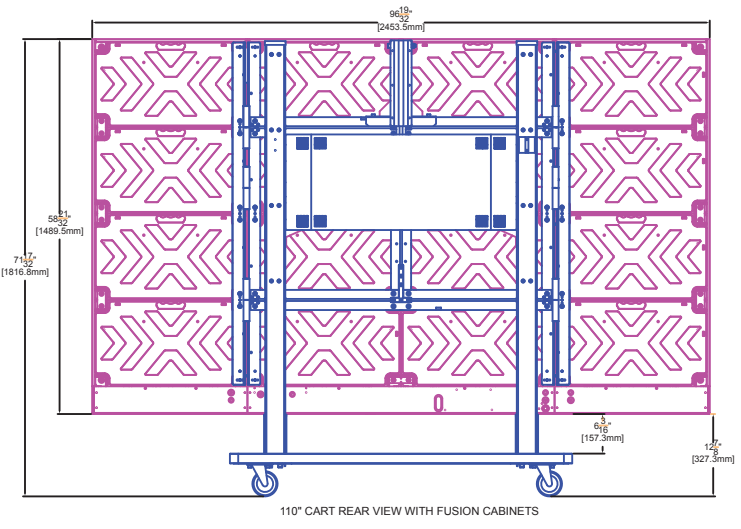
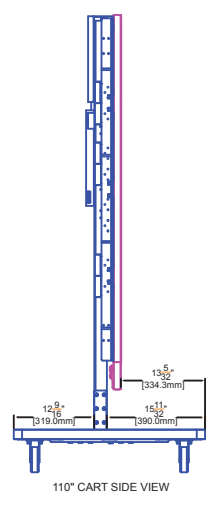
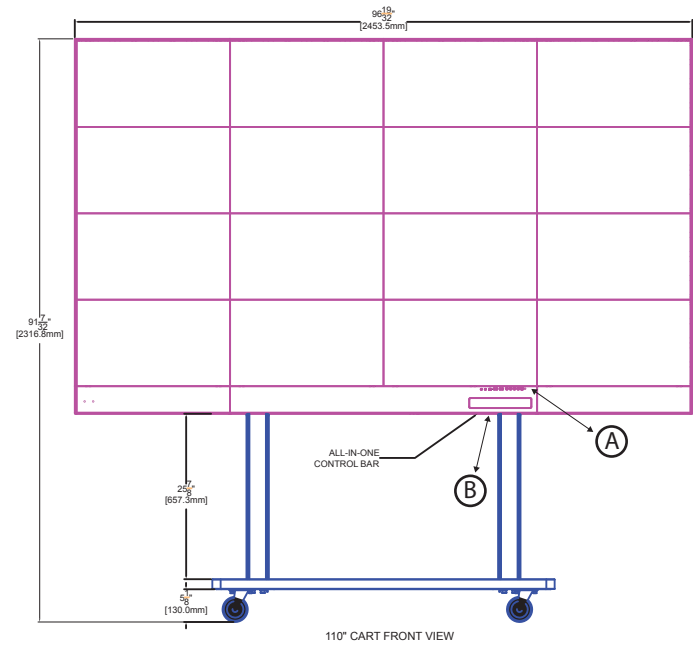

## 110" PRVFMX2G110A | CONNECTIVITY

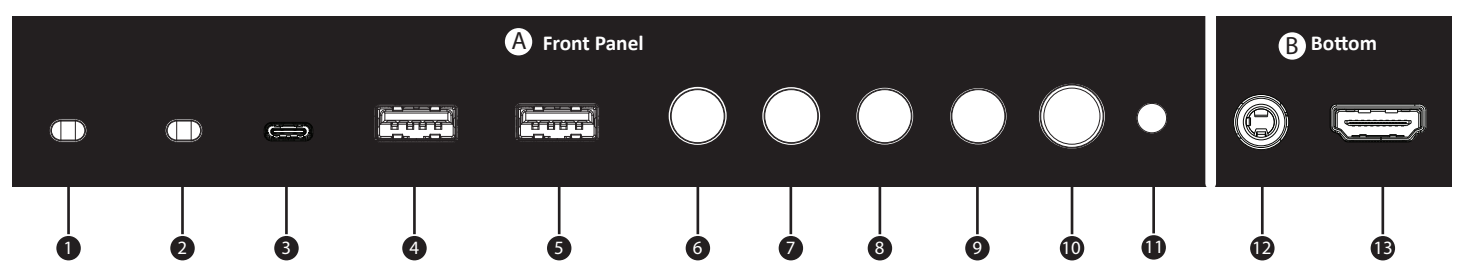

- |                |               |                                 |                             |
|----------------|---------------|---------------------------------|-----------------------------|
| 1 Light Sensor | 4 USB 3.0     | 7 OK / Direct brightness Button | 10 Standby / boot up button |
| 2 IR Receiver  | 5 USB 2.0     | 8 Down / Decrease button        | 11 LED Status indicator     |
| 3 USB Type-C   | 6 Menu Button | 9 Up / Increase button          | 12 HDMI 1.4 IN              |
|                |               |                                 | 13 3.5mm Audio OUT          |